

## MEMORY CARE



1:00 pm  
Spend the  
afternoon  
with my mother

### MEMORY CARE AT NEWHAVEN COURT

Newhaven Court offers an exceptional option for seniors with memory impairments, one that provides maximum comfort for residents and peace of mind for their families.

Here residents will enjoy a relaxing environment complete with beautiful landscaping and cozy areas for enjoying time with family and friends. The Memory Care Program provides a safe, warm and inviting environment conducive to emotional, spiritual and social satisfaction.

### MEMORY CARE RATE SCHEDULE

Private	\$6,043/month
Companion	\$4,464/month
Respite Stays—Per Person	\$212/day
<i>(Length of stay is minimum two weeks)</i>	
Community Fee (Non-refundable)	\$1,500
<i>Community Fee is per person, per move-in.</i>	
Personal Laundry Included in Daily Rate	

### ENHANCED CARE SERVICES - MEMORY CARE

Enhanced memory care services are available for residents who may require different levels of assistance. Charges are based on the Brief Cognitive Rating Scale (BCRS) and are detailed as follows:

Enhanced Care Level I Services	\$850/month
Enhanced Care Level II Services	\$1,050/month
Enhanced Care Level III Services	\$1,350/month
Enhanced Care Level IV Services	\$1,475/month

### COMMON ANCILLARY SERVICES

Incontinence Laundry  
Full Service Salon  
Transportation Services

# NEWHAVEN ~ COURT ~

at Lindwood™



Follow us on  
Twitter



Like Us on  
Facebook



A Welcoming Home  
For Veterans



Pets Welcome



EQUAL HOUSING  
OPPORTUNITY



Handicap

[www.IntegraCare.com](http://www.IntegraCare.com)

\* Rates effective 01/01/2021 for the 2021 calendar year.

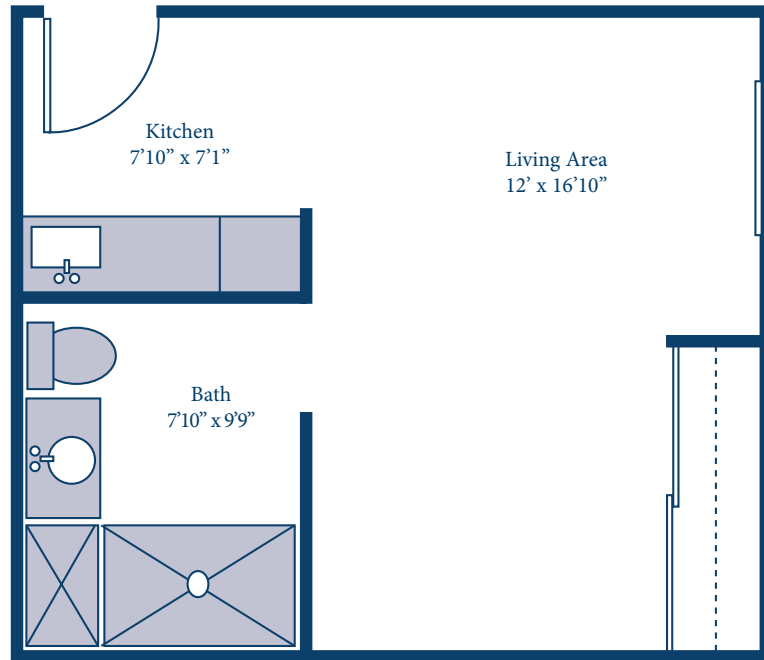

**PRIVATE & COMPANION**  
*Approx 331 Sq. Ft.*

# RATE SCHEDULE / FLOOR PLANS



10:30 am  
Buy my granddaughter  
a treat at Country Store

2:00 pm  
Hair Salon Appointment

6:30 pm  
Bridge Tournament

## YOUR HOME AT NEWHAVEN COURT

Each senior living apartment home provides residents with privacy, comfort and the added security of an easily accessible emergency communication system. Each apartment also includes ample closet space, large bathroom, individual climate controls, housekeeping and daily linen services. Residents can furnish their own apartment however they like and make it their own with favorite furnishings and family photos.

## RATE SCHEDULE

Studio	\$3,550 - \$3,912/month
Studio Deluxe	\$3,929/month
One-Bedroom	\$4,102 - \$4,358/month
One-Bedroom Deluxe	\$4,298 - \$4,788/month
One-Bedroom Deluxe Two	\$4,652 - \$5,089/month
One-Bedroom Alcove	\$5,028/month
Companion	\$3,104/month
Second Person Rate	\$1,576/month
Respite Stay	\$156/day
Community Fee (Non-refundable)	\$1,500
<i>Community Fee is per person, per move-in.</i>	

## ENHANCED CARE SERVICES

Enhanced senior living services are available for residents who may need additional assistance, based on assessment. Charges are based on the Resident Functional Assessment Scale and are detailed as follows:

Enhanced Basic Plus Services	\$385/month
Enhanced Care Level I Services	\$850/month
Enhanced Care Level II Services	\$1,050/month
Enhanced Care Level III Services	\$1,350/month
Enhanced Care Plus (Special Needs)	\$1,475/month

## COMMON ANCILLARY SERVICES

Pets Welcome! Pet Deposit  
*(one-time fee, non-refundable, ask staff for details)*

Telephone Charges *(one-time hook-up fee)*

Cable Television Installation *(one-time hook-up)*

Full Service Salon

Personal Laundry Services

Transportation Services

# NEWHAVEN ~ COURT ~

at Lindwood™



Follow us on  
Twitter



Like Us on  
Facebook



A Welcoming Home  
For Veterans



Pets Welcome



EQUAL HOUSING  
OPPORTUNITY



Handicap

[www.IntegraCare.com](http://www.IntegraCare.com)

\* Rates effective 01/01/2021 for the 2021 calendar year.

**WELCOME TO THE NEIGHBORHOOD!**

Newhaven Court at Lindwood's private apartments are grouped into smaller neighborhoods located off the main hallways. Each individual neighborhood shares a spacious great room with cozy seating and television area, as well as an outdoor patio.

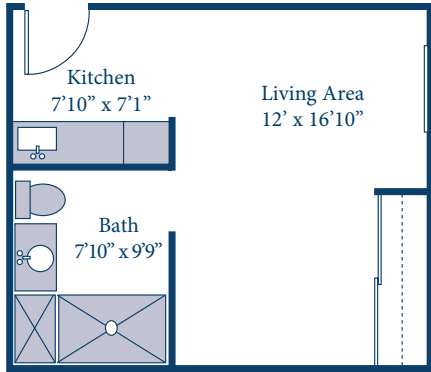

**STUDIO**

*Approx 321 Sq. Ft.*

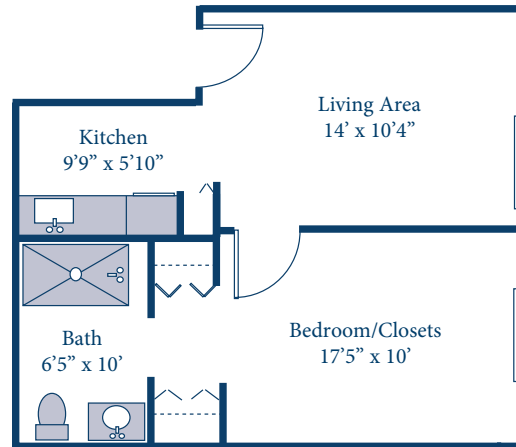

**DELUXE ONE-BEDROOM**

*Approx 439 Sq. Ft.*

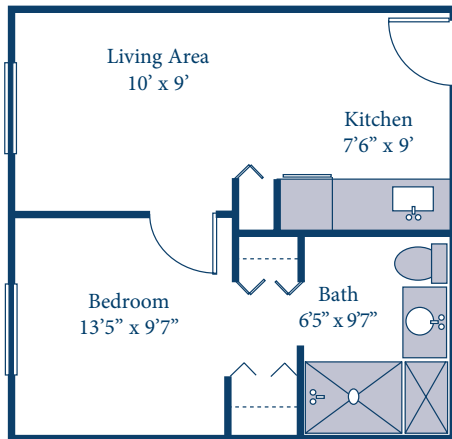

**STANDARD ONE-BEDROOM**

*Approx 351 Sq. Ft.*

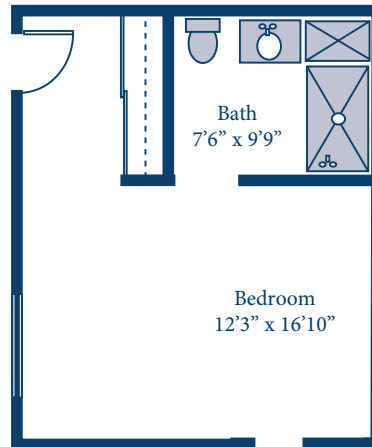

**TWO-BEDROOM**

*Approx 658 Sq. Ft.*

